

West Boundary of Pennsylv<sup>a</sup>.

William White.

John Wharton.

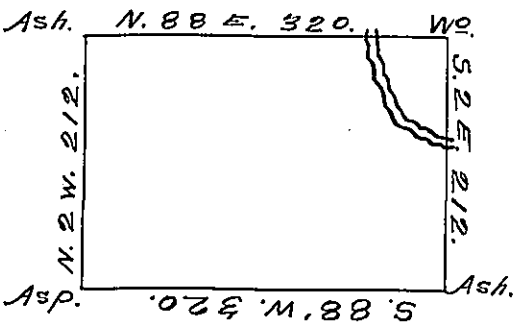

Israel Wheeler.

The above is a draught of a survey made the 7<sup>th</sup> of June 1796 in pursuance of a Warrant granted John White on the 14<sup>th</sup> April 1792 Situated on the waters of Big Beaver Creek in Alleghany County Containing four hundred acres and allowance of six per Centum Called Standish.

Daniel Brodhead Esq. }  
 Surveyor General of Penn<sup>a</sup>.

Thomas Stokely  
 D.S.

Now Mercer County.

IN TESTIMONY that the above is a copy of the original remaining on file in the Department of Internal Affairs of Pennsylvania, made conformably to an Act of Assembly approved the 16th day of February, 1833, I have hereunto set my Hand and caused the Seal of said Department to be affixed at Harrisburg, this tenth day of May 1907.

*Henry Fowler*  
 Secretary of Internal Affairs.